

7 . put sauna stone

After installing the sauna heater and controller, put appropriate sauna stone(10-15KG) on heater.

Notice: It's high temperature inside heater, so must use superior sauna stone. The poor heat resistant sauna stone will crack after heating and watering and damage the sauna heater. Or to be readily and block the heat circulate then damage the heater

8 . picture

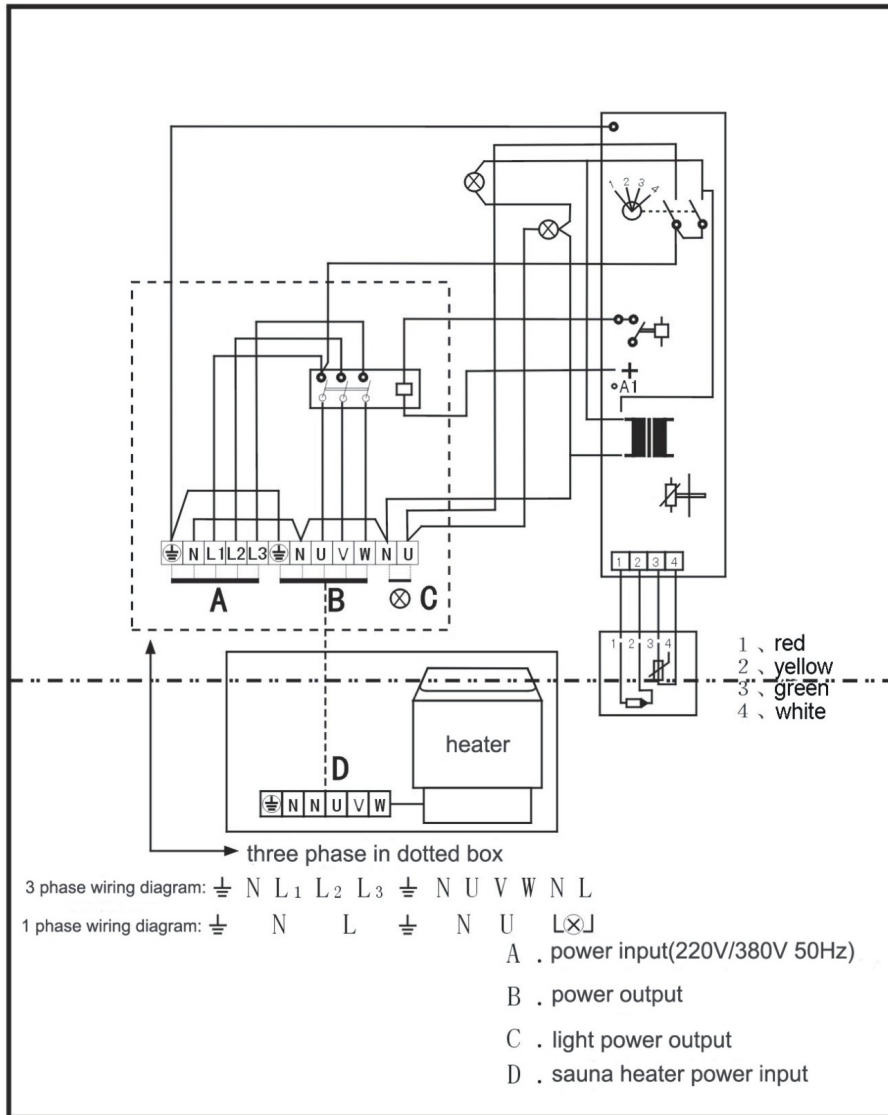

# Digital display outer controller

## Instruction book

Product Standard : **GB4706.31—2003**

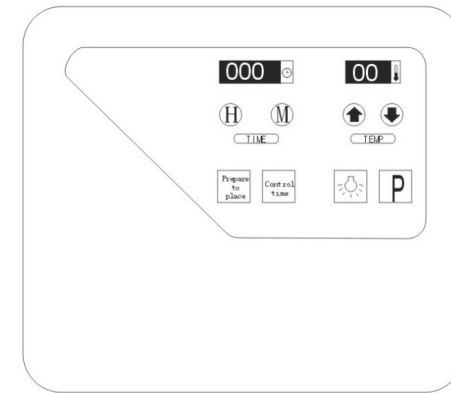

- ① A.C. contact LC1-D2510 fit to 9-21KW sauna heater
- ② A.C. contact LC1-D1810 fit to 3-9KW sauna heater

**WARNING:** please read this book carefully before using  
no further notice for changed part

This controller is splash proof. You can install it near the sauna room. Temperature detector must install on inside room wall. Please install according to the diagram to prevent burning the wood wall

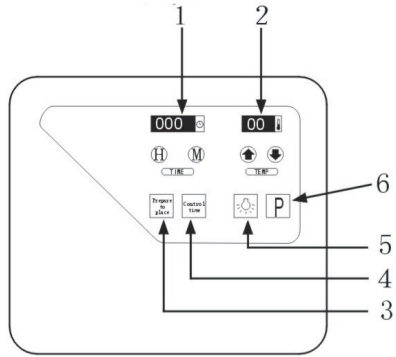

- 1、time
- 2、temperature
- 3、power-on by alarm
- 4、power-off by alarm
- 5、light power switch
- 6、confirm button of timing

## Digital display outer controller

### 1. usage of heater operative mode switch and time/temp control

#### A. proofread time:

Press H to adjust hour. After several blinking, it will confirm automatically

The same as M to adjust minutes

#### B. power-on by alarm: (at most 24 hours)

pressing prepare to place, then pressing H,M button to set time. It will confirm automatically after several blinking

#### C. power-off by alarm:

press control time button, the display will be blinking and then adjust power-off time (at most 5 hours, at least 1 minutes). It will confirm automatically after several blinking.

#### D. After power on, press P button to let temperature work, use +/- button to adjust temperature. Do not under timing control

### 2. temperature detector

Temperature detector recommended install dimension. (refer to the heater install diagram. Along with a 3M heat-resistant wire to extend to outside with common low tension wire

### 3. installation of temp detector

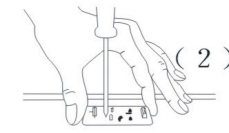

Fix the detector circuit board upon the sauna heater with screw

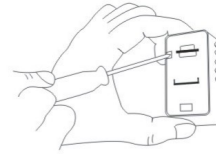

Use screwdriver to remove (1) the cover at the edge of the detector circuit board

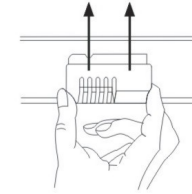

Fix the cover (3) on the detector circuit board

### 4. limit control

If the temperature is too high inside the sauna room like the temperature controller breaks down, the temperature limiter in the temperature detector will cut power off and reset automatically after trouble removal.

### 5. installing diagram

temperature detector and heater must be installed according to the picture. Or there may be a fire because of high temperature

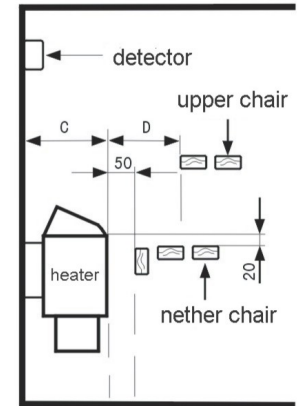
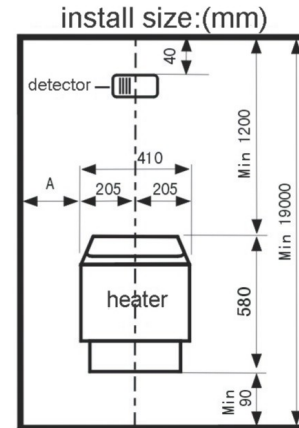

heater	distance (mm)		
	A	C	D
3KW	50	280	80
4.5KW	80	280	100
6KW	100	280	150
8KW	130	300	200
9KW	130	300	200

### 6. power connection

(1) Connect the phase line to controller power input end L1, L2, L3 respectively. Null line [neutral line] connect to input end N. protective earth wire attach to  $\perp$

(2) Use the heat resistant conductor to connect the controller power output end with the heater input end according to the same symbol.